









SINALIZAÇÃO LED DE SEGURANÇA – TIPO DISPLAY

LED – CONFIGURÁVEL – VISIBILIDADE 2KM



	A. Flashing arrow right	B. Flashing arrow left	C. Flashing double arrow	D. Flashing caution-bar warning
Pulse 1				
Pulse 2				

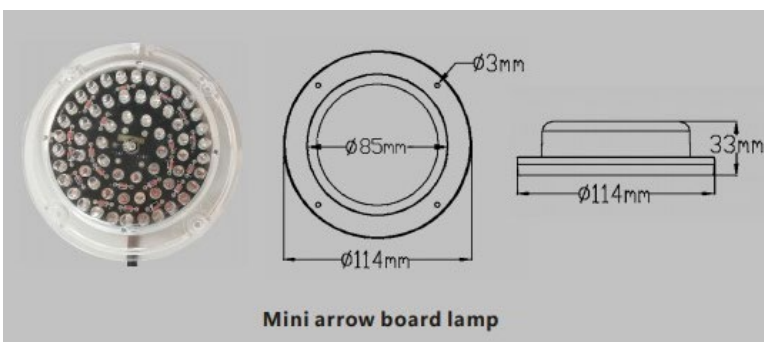



Distribuidor Brasil



CARACTERÍSTICAS:

- Material: Chapa de alumínio com pintura à pó.
- Dimensões: 1410*365*85mm (ou customizada sob encomenda).
- IP 64 – à prova d'água.

RECURSOS:

- LED's âmbar de alto brilho com visibilidade acima de 2000m.
- Fácil de operar.
- Fácil manutenção.
- Setas e outros padrões podem ser selecionados pelo usuário usando a caixa de controle.

CÉLULAS:

- Cada célula possui 60 LED's âmbar de alto brilho.
- Ângulo 16°.
- Visibilidade acima de 2km.
- Material PC.
- Frequência 60 pulsos/minuto (ou customizado sob encomenda).

CAIXA DE CONTROLE:

- Material ABS.
- Baterias de Li-ion recarregáveis.

MEGA SP Comércio de Sensor Eireli – ME
Endereço: Rua Liliental, 247 - Bairro Pq. Edu Chaves
CEP 02231-000 – São Paulo – SP – Brasil
Telefone: 11-3938-5313 – Mobile/WhatsApp: 11-97162-7722
E-mail: vendas@megasensor.com.br



SGL-001(WIFI)

EVERY LITTLE LIGHT FOR SAFETY

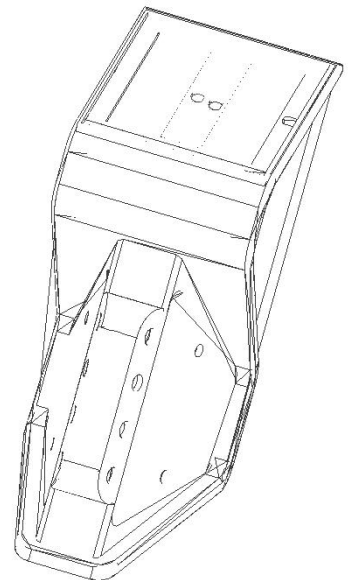

Contents

Contents.....	2
1 Scope.....	3
2 Products Description.....	3
2.1 Features.....	3
2.2 Mechanical.....	3
2.3 Electrical.....	3
2.4 Optical.....	3
3 Structure Diagram.....	4
4 Flashing Mode Diagram.....	4
5 Installation.....	4
5.1 Applicable Place.....	4
5.2 Installation Diagram.....	4

www.megasensor.com.br

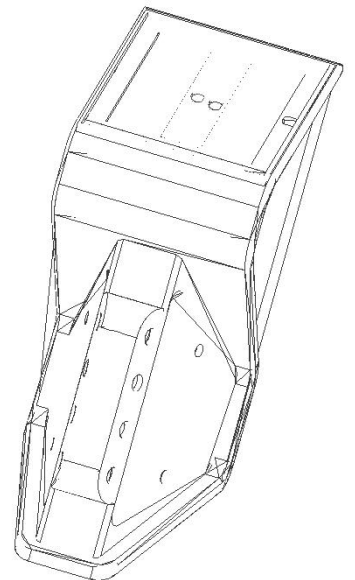

1 Scope

This specification covers the detailed Specification and Performance for the following products listed at below:

2 Products Description

2.1 Features

2.1.1 Robust construction, suitable for harsh conditions.

2.1.2 Low maintenance.

2.1.3 Operation Mode: Synchronous flash/Sequential flash (optional).

2.1.4 Optional:Acrylic reflector can be replaced by reflective film.

2.1.5 Outstanding visibility during the day and at night.

2.1.6 Photocontrol, automatic on at dusk ,off at day, save energy, Friendly to the environment.

2.1.7 External magnet switch(optional):Special design of the internal circuit to make this guardrail light to be turned on/off by an external mini-magnet, good for long time storing.

2.2 Mechanical

2.2.1 Product Material: PP, Acrylic reflector,Iron

2.2.2 Product Size: 253(L)*97(W)*91(H)mm

2.2.3 Product Weight: 365g

2.2.4 Protection Index: IP65

2.2.5 Operation Mode: Synchronous flash/Sequential flash (optional).

2.2.6 Function: Photocontrol, automatic on at dusk ,off at dawn, save energy, friendly to the environment.

2.2.7 Work Temperature: -10°C to $+50^{\circ}\text{C}$

2.3 Electrical

2.3.1 Power Supply: Solar Panel

2.3.2 Solar Panel Type: 5V 110mA

2.3.3 Solar Panel Size: 88*88mm

2.3.4 Battery: 3.7V 2000mAh lithium battery

2.3.5 Lighting Time: 70H after fully charged

2.4 Optical

2.4.1 LED Qty: 4pcs +4pcs LEDs

2.4.2 LED Type: $\Phi 8\text{mm}$

2.4.3 Visual Distance: 500M

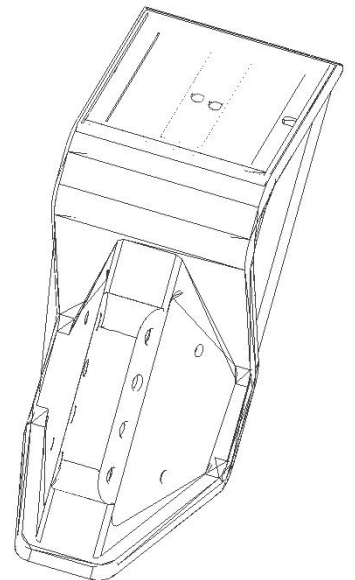

3 Structure Diagram

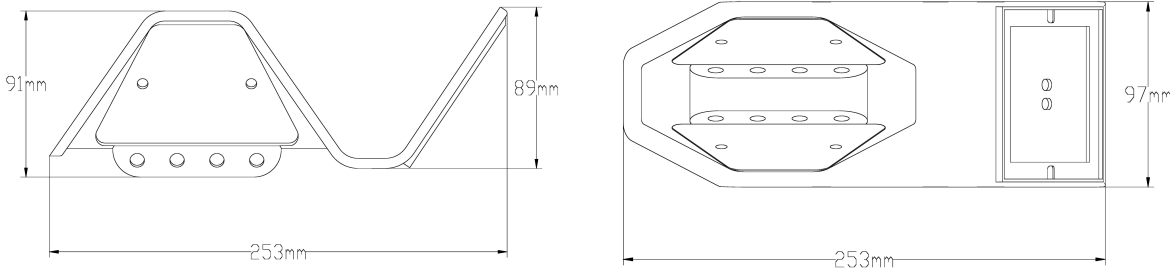

4 Flashing Mode Diagram

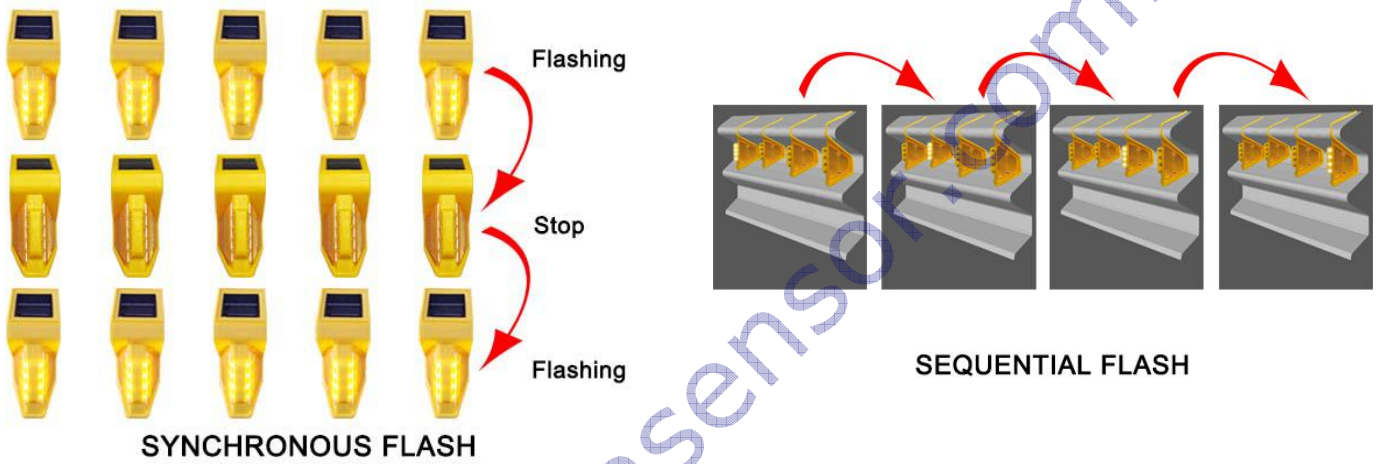

5 Installation

5.1 Applicable Place

Used on highway guardrails for road safety.

5.2 Installation Diagram

