

ILUMINAÇÃO LED PARA ÁREAS DE TRABALHO



QML-150-D



QMHL-250-MF

Water, Vibration and Oil Resistant LED Work Lights with IP67/ IP69K Protection

Water, vibration and oil resistant LED work light, suitable for machine tools applications and high temperature water cleaning environments

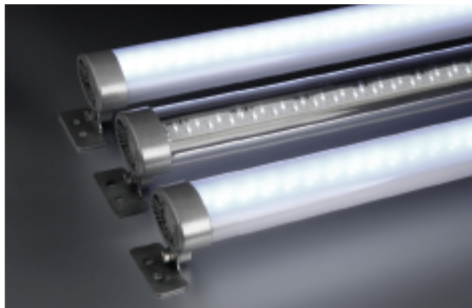

QFL/ QFLC



Water and Vibration Resistant LED Light Bars with IP67 Protection

Excellent heat dissipation by using a heat dissipative material connected to the outer cover



QMFLN



Water, Vibration and Oil Resistant LED Work Lights with IP67/ IP69K Protection
38(W)X64(H)X190-6



QPL/ QPLC



QPHL/ QPHLC

Basic Waterproof LED Light Bars
39.4(W)X24.4(H)X200-500(L)

Waterproof LED light bars, suitable for dusty and moisture environments

ILUMINAÇÃO LED PARA ÁREAS DE TRABALHO

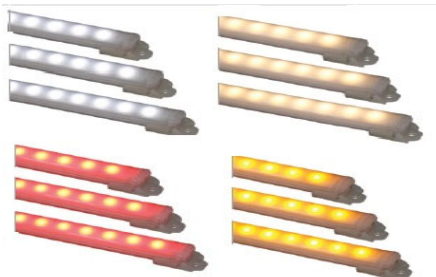

QCML/ QCMLC



Waterproof LED Light Bars for Multi-use with Protection of IP67/ IP69K
33(W)X26(H)X257~1557(L)

High seal and high waterproof light bars that can be used in high temperature wash down applications



QCML-7C-24



Waterproof LED Light Bars for Multi-use with Protection of IP67/ IP69K
33(W)X26(H)X257~1557(L)

Waterproof LED light bar with 7 color configurations

1 Lâmpada x 7 cores selecionáveis



QGL/ QGLC



LED Light Bars for Indoor
38.4(W)X33.6(H)X200~500(L)

General lights for built-in AC power converter in compact structure



ILUMINAÇÃO LED PARA ÁREAS DE TRABALHO



QEL-QELT-QELS- QELST



LED Light Bars for Distribution Panel
34.6(W)X30.7(H)X220~520(L)

External Power Line



ULEF / ULESF



Fluorescent LED Lights for General Purpose
300(W)X1200(L),
300(W)X600(L),600(W)X600(L)

Fluorescent LED Lights for General Purpose
300(W)X1200(L),
300(W)X600(L),600(W)X600(L)



ULPL



Fluorescent LED Light
65(W)X55(H)X1200(L)

Fluorescent LED Light
65(W)X55(H)X1200(L)



ULFL



LED Light for General Purpose
Φ26X1200(L)

LED Light for General Purpose
Φ26X1200(L)

ILUMINAÇÃO LED PARA ÁREAS DE TRABALHO



ULII



Indirect LED Light
22(W)X1200(L), 22(W)X900(L),
22(W)X600(L), 22(W)X300(L)

Indirect LED Light
22(W)X1200(L), 22(W)X900(L),
22(W)X600(L), 22(W)X300(L)



110°
Clear Cover



100°
Frosted Cover



60°
Wide Flood Lens

SL65/SL75/SL80-N4



110° Clear Cover High Bay LED Lights
ø264x163(body)

ILUMINAÇÃO LED PARA ÁREAS DE TRABALHO



SL120N4-KE-CRB(PF)



100° Wide Flood Lens High Bay LED Lights
ø288x174(body)

ILUMINAÇÃO LED PARA ÁREAS DE TRABALHO

LUMINÁRIA LED À PROVA DE EXPLOÇÃO (EX)

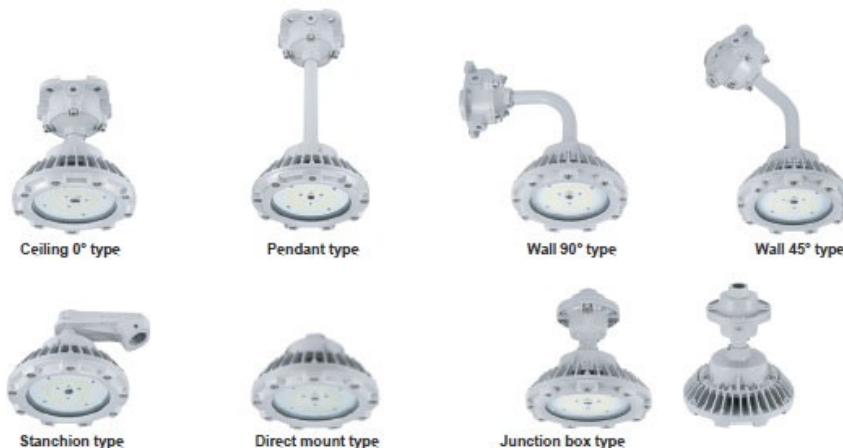

EXD29-JE-CJ



Junction box type Explosion Proof High Bay LED Lights
ø240 x 290

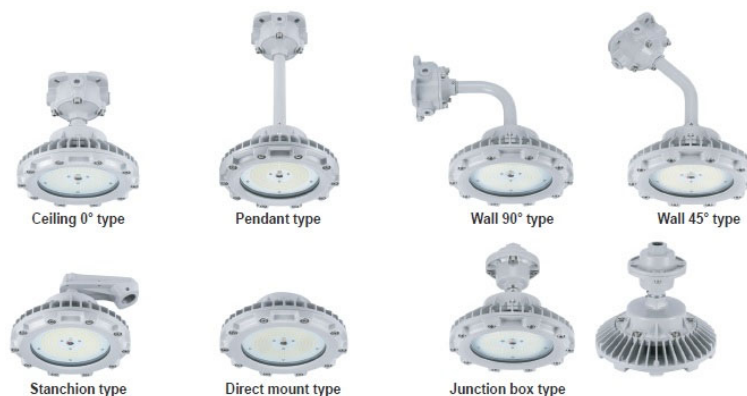

EXD43/EXD57/EXD80



Direct mount type Explosion Proof High Bay LED Lights
ø240 x 150

ILUMINAÇÃO LED PARA ÁREAS DE TRABALHO



QLEX-350



Explosion Proof LED Work Light

Explosion proof LED work light designed for use in explosive gas environments with Ex d IIC rating



QMFL300-Ex-24



Water, Vibration and Oil Resistant LED Work Lights with IP67/
IP69K Protection

Suitable for machine tool equipment that needs excellent water and oil
proof features



Distribuidor Brasil

ILUMINAÇÃO LED PARA ÁREAS DE TRABALHO



www.qlight.com

CWA

LED Light Bar



Daylight

IP65

Affordable replacement for fluorescent lighting.

An affordable replacement, the slim LED light bar can outperform a conventional fluorescent lamp. The protection rating of IP65 is a standard which allows installation in most common environments.

FEATURES

- Available for DC 24V applications
- Long-lasting LED's greatly reduce maintenance costs
- Total luminous flux of 350lm, 100lx luminance at 1m (Voltage: DC24V)
- A set of two stainless-steel mounting brackets is a standard accessory
- Operating temperature range from -30 to +60 degrees C.
- LED color temperature is Daylight (6500K)

How to Order

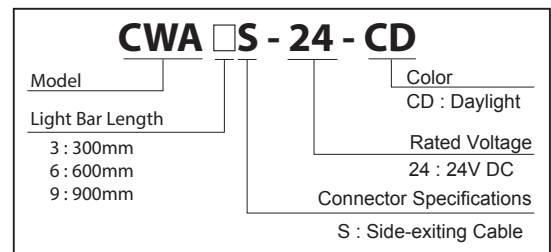

Specifications

Model	CWA3S-24-CD	CWA6S-24-CD	CWA9S-24-CD
Luminous Color	Daylight		
Color Temperature (typ.)	6500K		
Illuminance (at DC24V)	1.0m 440 lx	800 lx	990 lx
Total Luminous Flux (typ.)	350 lm	700 lm	1050 lm
Operating Voltage Range	24VDC ±10%		
Current Consumption	180mA	360mA	540mA
Rated Power Consumption	6W	12W	18W
Operating Ambient Temperature	-30°C - +60°C		
Operating Ambient Humidity	90% RH or less, no condensation		
Main Unit Material	Body: Polycarbonate Resin; Packing: Silicon		
Cable Length	3 meters		
Mounting Location	Indoors		
Protection Rating	IP65 (Cable ends not included)		
Insulation Resistance	500V DC 5MΩ or more		
Withstand Voltage	500VAC for 1 minute (Between terminals and screw)		
Vibration Resistance	30Hz 19.6m/s ²		
Mass (Tolerance ±10%)	215g	385g	540g

Standard Accessory



Highly reliable LED chips are used

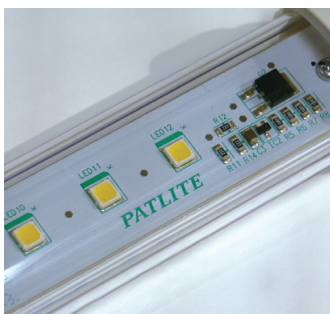

High-definition LED chip

The highly reliable LED chip, which is the core of LED lighting, has nearly 10 times (about 40,000 hours) the lifespan (based on LED brightness of 70%) in comparison to the common fluorescent light, it also does not contain any mercury.

A uniform light that subdues glare

In comparison to an LED luminous source, we take advantage of the straight beam optical characteristic of the LED without dropping brightness or overdoing it, but reproducing a natural light.

||llumination Distribution Chart

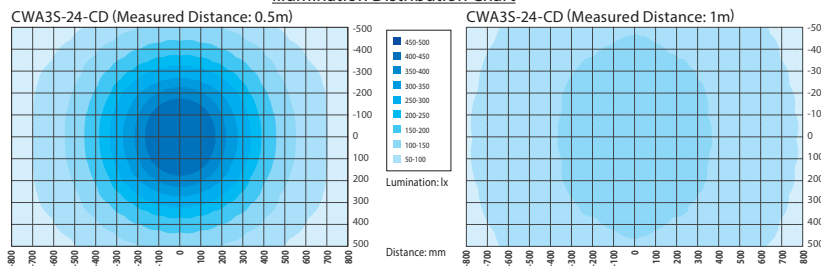

Cost Saving

Energy ab. **82.7%** Less

Based on 10 hrs. per day for 30 days

Annual Power Consumption	88kWh	15.3kWh
	100V20W Fluorescent	CWA LED Light Bar

Earth Friendly

CO2 Emissions ab. **80.7%** Less

Based on 10 hrs. per day for 30 days

CO2 Annual Power Consumption	31kg	6kg
	100V20W Fluorescent	CWA LED Light Bar

Long Life

Lifespan **9** times more

Lifespan	4,000 to 13,000Hrs.	36,000Hrs.
	Conventional Fluorescent	CWA LED Light Bar

Low Heat

In Comparison ab. **31%** Less

Measured 1 hr. after lighting

Heat Radiation	60°C At Room Temperature	41.5°C At Room Temperature
	Flourescent (FL20SS)	CWA LED Light Bar

Dimensions (Unit: mm)

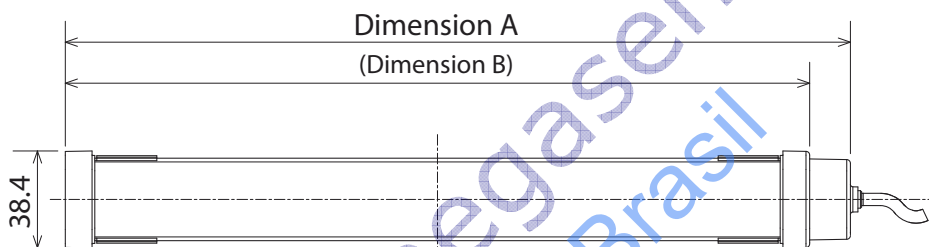

Model Name	Dimension A	Dimension B
	Total Length	Lighting Area
CLA3S	315.5	300
CLA6S	621.0	600
CLA9S	916.5	900

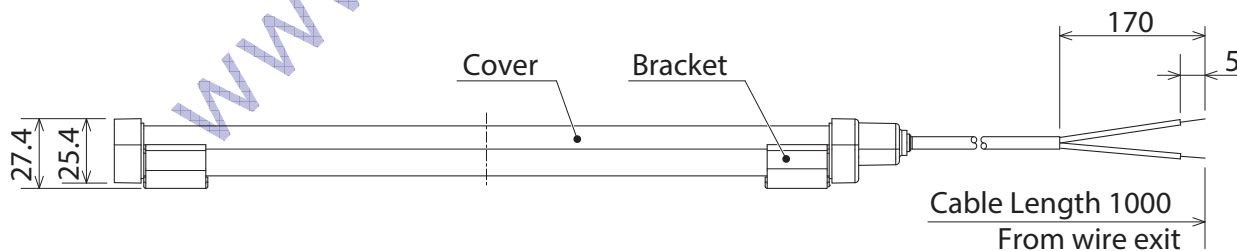

Wiring

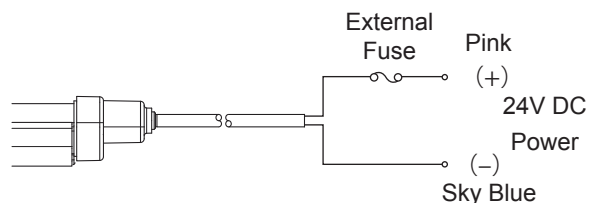

[Enforced]

There is no protection rating for the area surrounding the tip of the cable. To ensure insulation of water intrusion, the use of fillers (such as silicon, etc.) to plug up the tip part is recommended.

CLA

LED Light Bar



CLA-2S-CD



CLA-3S-CD

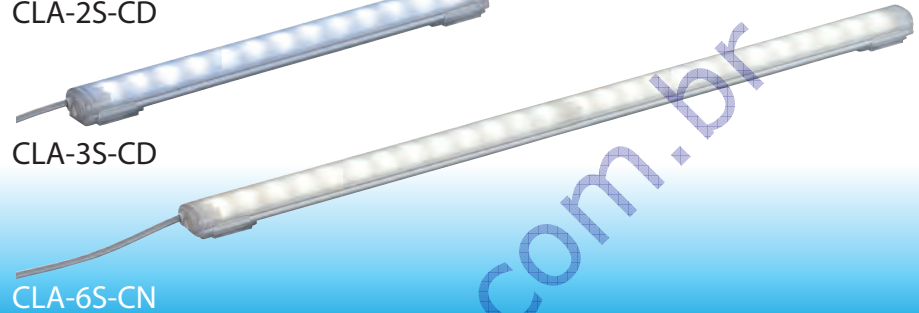

CLA-6S-CN

Daylight, Amber
Natural White



IP66/67/69K

More than a diffusion LED light bar, it can be used in places like the food-processing industry with its protection rating of "IP69K", which can endure high-pressurized hot water washing.

- Bright, long lasting LED's.
- Suitable for food, beverage and pharmaceutical applications where high-pressure, 80°C high-temperature wash-downs are required. Also meets IP66/67 standards.
- The radiating temperature is reduced to 40 degrees or less (34% reduction in comparison to a 20W fluorescent light), increasing environmental efficiency.
- Six lengths in the range from 100 to 1200mm to choose from, with three colors (Daylight, Natural White, Amber), and four types of attachments, including a magnet one, offering a potential for various applications.
- The operating temperature range from -40°C to +60°C allows installation in sub-freezing temperatures, such as walk-in freezers.
- It is constructed with strong polycarbonate resin, which is resistant to shock.
- Corresponds to Europe's RoHS Directive.
- Obtained certification for ECOLAB.
- Conforms to CE requirements.
- UL Listed (File No. E306141).

Luminous Color

With a high-intensity lumination, its suitable for applications such as lighting processing machinery workspace, for lighting up a video inspection system to light up more details, etc.



A 6800K daylightlight light bar at a distance of 50 cm from the center of irradiation has measured a maximum brightness of 400lx.

How to Order

CLA <input type="checkbox"/> S-24- <input type="checkbox"/> - <input type="checkbox"/>	
Model	Cable Length
Light Bar Length	Blank : 0.5m 30 : 3.0m
1 : 100mm	Luminous Color
2 : 200mm	-CD (Daylight)
3 : 300mm*	-CN* (Natural White)
6 : 600mm	-Y* (Amber)
9 : 900mm	
12: 1,200mm	
* -Y is only available in 300mm lengths	
* -CN is only available in 600 and 900mm lengths.	

Discontinued



CLA-CN (Natural White: 4800K)



CLA-CD (Daylight: 6800K)



CLA-Y (Amber)

Dimensions (Unit: mm)

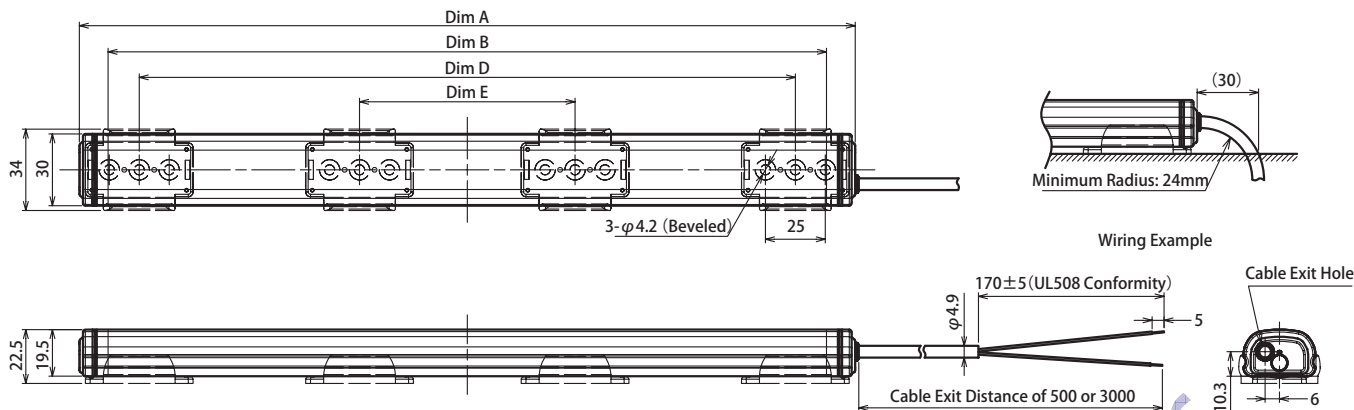

Model Name	Dim A	Dim B	Dim D	Dim E	Standard Bracket SZ-310AR
	Total Length	Lighting Area	Mounting Pitch		
CLA1S	124	100	74	—	2 pcs.
CLA2S	224	200	174	—	
CLA3S	324	300	274		
CLA6S	624	600	574		
CLA9S	924	900	874	290	4 pcs.
CLA12S	1,224	1,200	1,174	390	

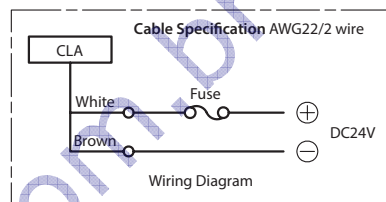

Options



Standard

Rear Attachment
(Screw Mount)
Model SZ-310AR



Option

Rear Attachment
(Magnetic Mount)
Model SZ-310ARM



Option

Side Attachment
(Screw Mount)
Model SZ-310AS



Option

Side Attachment
(CLB-24N Compatible)
Model SZ-310ASB

Specifications

Model	Luminous Color	Rated Voltage	Vibration Resistance	Operating Temperature Range	Rated Current Consumption	Center Radiation (lx/50cm)	Main Body Material	Protection Rating	Mass
CLA1S -24 -CD	Daylight	DC 24V (Polarized)	19.6 m/s ²	-40°C - +60°C (RH 90% or less)	104mA	140	Polycarbonate	IP66/67/69K	80g
CLA2S -24 -CD	Daylight				208mA	270			130g
CLA3S -24 -CD	Daylight				240mA	400			180g
CLA3S -24 -CN	Natural White					220			
CLA3S -24 -Y	Amber				480mA	650			340g
CLA6S -24 -CD	Daylight								
CLA6S -24 -CN	Natural White				720mA	810			500g
CLA9S -24 -CD	Daylight								
CLA12S -24 -CD	Daylight	960mA	890	660g					

PATLITE
New Frontiers in Safety, Security and Comfort.